

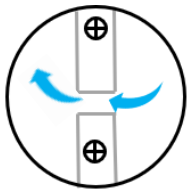

STS Construction Board – Typical Fixing Details
EXTERNAL RENDER CARRIER
 400mm Centres – Upright Layout

25mm x 50mm Treated Battens
 @ 400mm centres

We recommend leaving a 10-20mm space between upright battens to allow free movement of air laterally.



No. Fixings = 28

STS 35mm HD Ext Screw

No. Fixings = 21

Material:
 Steel - Impreg®+ coating

Features:

- CE marked to EN14566
- PH drive
- Ribbed countersunk head
- Drill point
- Twin thread
- Impreg®+ coating

SKU	Fastener Dimensions (mm)			Driver Bit	Box Qty
	d	l	d _h		
5603	3.9	35	6.8	PH2	250

